

Installation Manual

Alinya - ALN-F

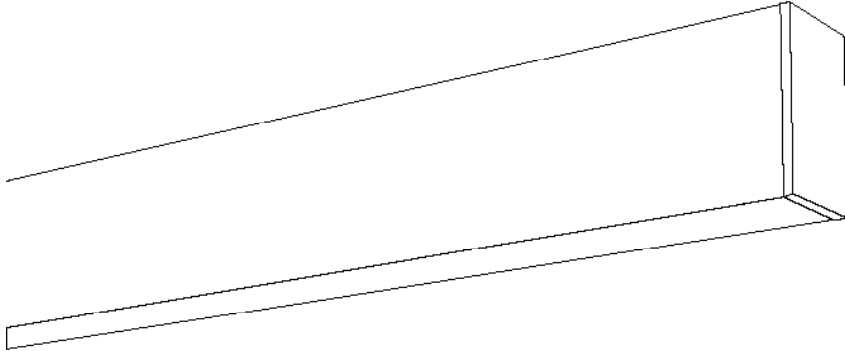

CAUTION:

- For any questions or issues that are not included in this manual, please contact the manufacturer for information about possible solutions.
- Adherence to work, health and safety requirements should always be observed when undertaking the works contained in this installation manual.

THE MANUFACTURER IS NOT RESPONSIBLE FOR DAMAGE CAUSED BY FAILURE TO ADHERE TO INSTRUCTIONS PROVIDED IN THIS MANUAL.

Product Overview

- LED Extrusion Luminaire
- Custom made to project lengths and angle
- Suitable for indoor use only
- For ceiling surface mount applications
- Rated current ~ 0.3A per linkable module

Instructions

- The maximum recommended combined total meterage of this linear LED extrusion to be connected to a 20A RCD protected circuit is 80m.
- As type 'AC' combination RCD/MCBs are prone to nuisance tripping it is recommended that only type 'A' RCD/MCBs be used.

1 Remove Diffuser

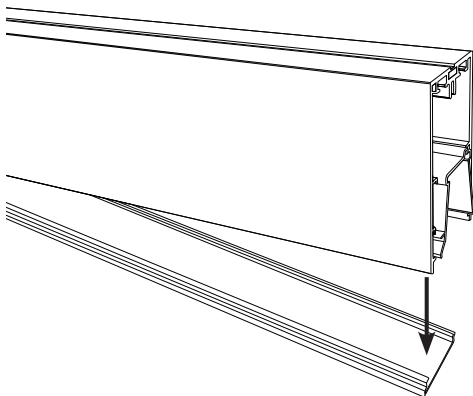

3dWZVW_gf[bWf][Y
g`[fe1

- Yes → Go to 2
No → Go to 4

2 Remove Reflector

To gain access to the latch, the reflector will either need to be slid up the extrusion, or removed if there is an end cap.

No End Cap:

Using your fingers slide the reflector along the extrusion.

or

With End Cap:

Place a screw driver in the side to remove the reflector. (See below)

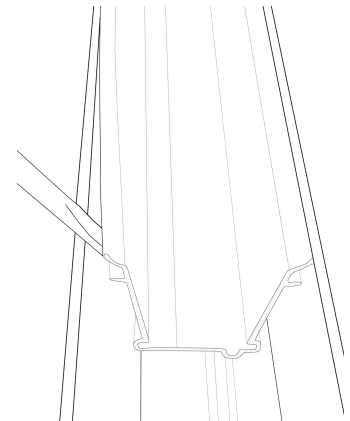
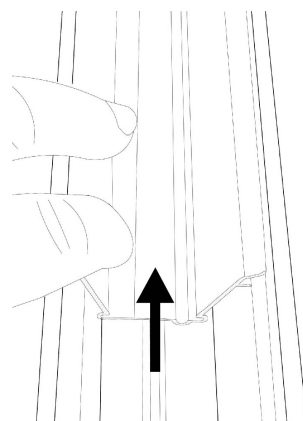

3| Connect Sections

Lay the sections down end-to-end, matching the compatible ends to each other, and position them ready to secure. Once in the correct order and placement, fasten the latches as seen below. The reflector can then be replaced into position.

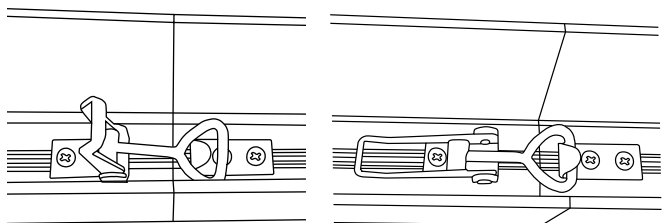

4| Wiring

Isolate or turn power off. Connect the cables using a Clipsal 559A3 Junction box.

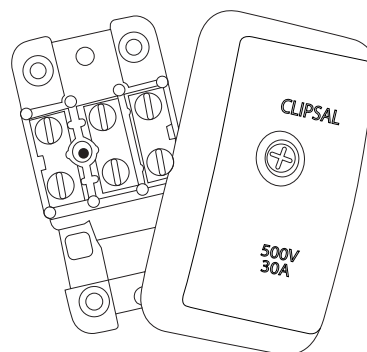

5| Mounting the Luminaire

Lift the luminaire into mounting position. Screw up into the ceiling through the pre-drilled mounting holes in the extrusion. Access is through the pre-drilled holes in the reflector.

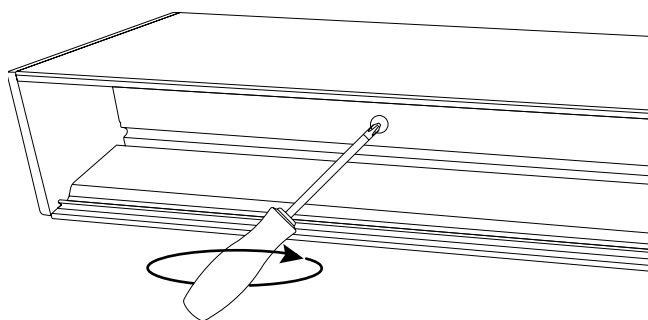

6| Replace Diffuser

Clip the diffuser back into place

