

HUBBLE

IGR175 - INGROUND ROUND LUMINAIRE



The Hubble Inground Round Luminaire for Vision is the perfect way to complete any outdoor wall-washing and up-lighting effect project. It is constructed to IP67 and IK10 ratings using stainless steel and die-casting for the body.

The Hubble has a protective membrane that enhances reliability by reducing condensation and contaminants issues.

Incorporating quality LED componentry ensures a high lumen output and colour consistency. Available in various lenses for wall-washing effect and beam angles to meet different requirements.

The Hubble perfectly complements a range of exterior applications for pathways, building facades, parks, gardens and stairways.

PRODUCT SPECIFICATIONS

Wattage:	15W
Lumens:	1200 Lm (Symmetrical) 700Lm (Asym)
CCT:	2700K 3000K 4000K
CRI:	Ra>80
Beam Angle:	25° 45° 60° 80° Asymmetric
Input Voltage	24V dc
Dimming:	With suitable driver
Material (Heatsink):	Cast Aluminum
Material (Trim):	Stainless Steel
IP Rating:	IP67
IK Rating:	IK10
Mounting:	Inground
Lifetime:	L80B50>60,000 hrs

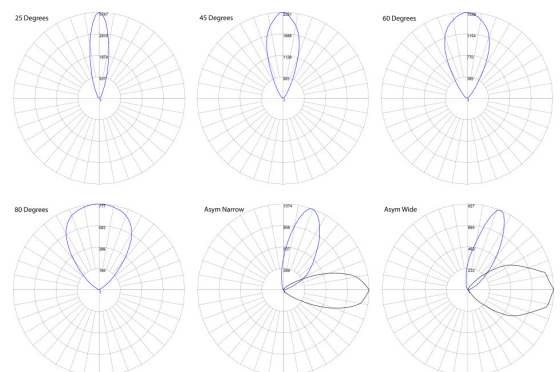

HUBBLE

IGR175 - INGROUND ROUND LUMINAIRE

CODING MATRIX

Family	Power		CCT		Beam angle	
IGR175	-15W	15.5W	-27K	2700K	-25D	25°
			-3K	3000K	-45D	45°
			-4K	4000K	-60D	60°
					-80D	80°
					-A40	Asymmetric Narrow
					-A70	Asymmetric Wide

DIMENSIONAL DIAGRAM

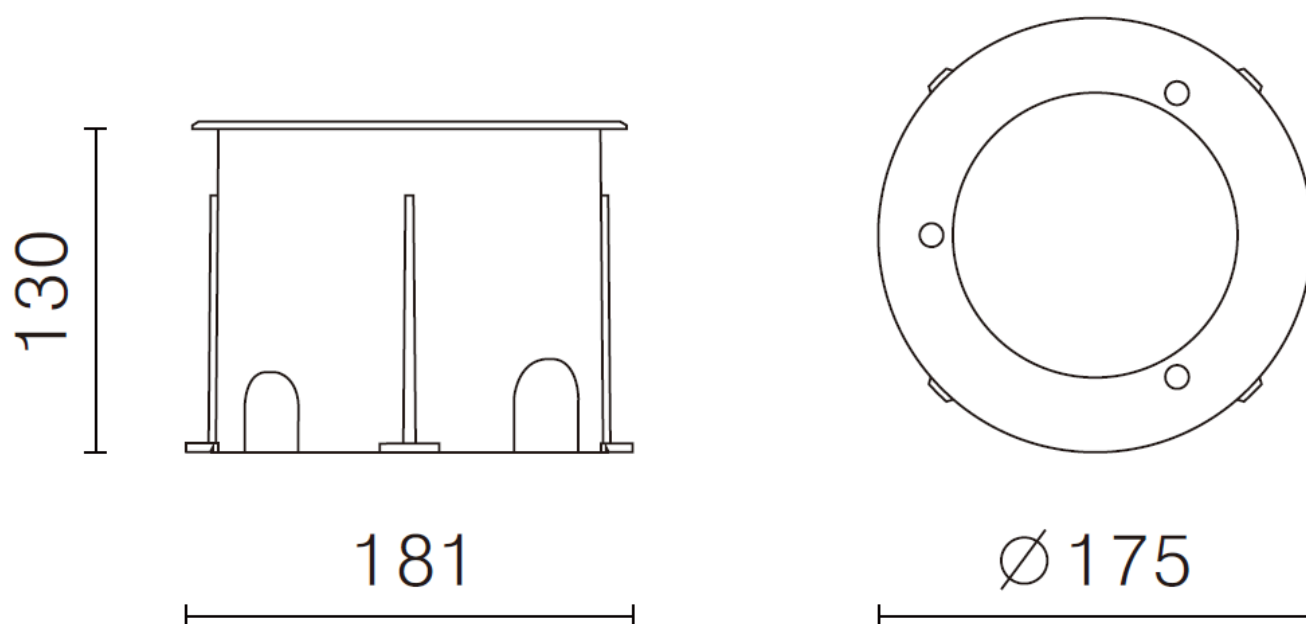

HUBBLE

IGR175 - INGROUND ROUND LUMINAIRE

PROTECTIVE VENTS

- Minimising condensation through more effective vapour diffusion.
- Providing rapid pressure equalisation to extend seal life and avoid failure
- Preventing entry of contaminants like dust, dirt and other debris.

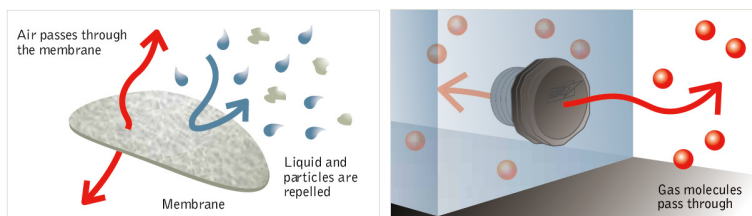

DRIVERS - STANDARD NON-DIMMABLE

- Max distance 45m from driver
- Wiring in parallel

Quantity up to:	Driver Model
4	DRV-VS-24V-IP67-75W
6	DRV-VS-24V-IP67-100W
9	DRV-VS-24V-IP67-150W
12	DRV-VS-24V-IP67-200W

DRIVERS - DALI

- Dimming via PWM dimming method only. Amplitude Dimming not suitable.
- Max distance 45m from driver
- Wiring in parallel

Quantity up to:	Driver Model
3	DRV-MW-PWM-60-24-DA
7	DRV-MW-PWM-120-24DA
20	DRV-PWS-DDV-320-24-AUP

DRIVERS - IP20 ECONOMY OPTION

- IP20 option is more cost effective. Contractor to ensure they are installed in a suitably IP protected location.
- Max distance 45m from driver
- Wiring in parallel

Quantity up to:	Driver Model
4	DRV-VS-24V-75W
7	DRV-VS-24V-120W
11	DRV-VS-24V-180W

HUBBLE

IGR175 - INGROUND ROUND LUMINAIRE

WALL WASH SPACING - NARROW

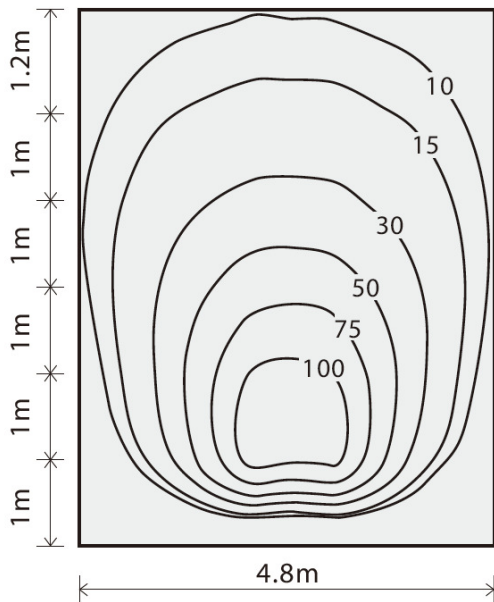

Suggested installation distance

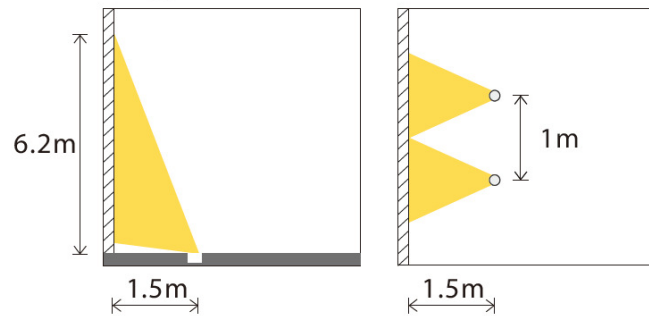

From the wall = 1.5m Between luminaires = 1m

WALL WASH SPACING - WIDE

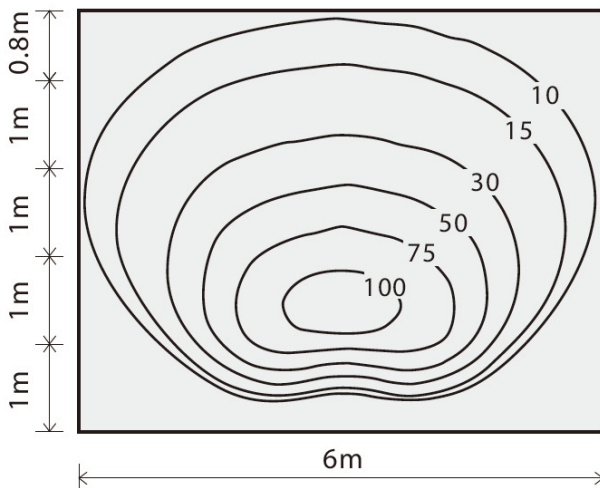

Suggested installation distance

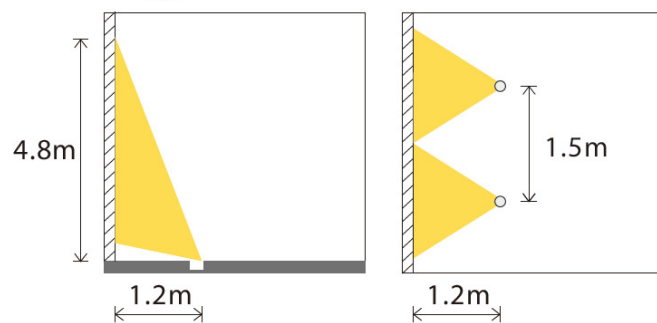

From the wall = 1.2m Between luminaires = 1.5m

HUBBLE

IGR175 - INGROUND ROUND LUMINAIRE

INSTALLATION GUIDE

IGR175-15W

LED In-Ground luminaire for walk or guide light on the hallway, garden, park.

If the external flexible cable or cord of this luminaire is damaged, it shall be exclusively replaced by the manufacturer or his service agent or a similar qualified person in order to avoid a hazard.

The light source of this luminaire is not replaceable; when the light source reaches its end of life the whole luminaire shall be replaced

Caution, risk of electric shock.

FIG-1
Installation place

FIG-3

FIG-4

Note: The concrete cannot cover the outer housing

FIG-5

FIG-7

FIG-8

FIG-6

FIG-9

The housing can be adjusted by twisting the hexagon screw of the housing, making the housing balanced with the floor. The height can be adjusted 1-3mm.

(red) = DC 24V Driver (black) = L (brown) = N (blue)

Note: to ensure long life span during operation, please prepare IP67 housing or relevant connector to connect external cable from luminaire to driver.

ON OFF